

TECHNICAL RATINGS		
AC-1 Resistive Amps	20A	
IEC AC-3	380V	9A
IEC AC-3	600V	5A
HP Ratings		
Three Phase	240V - 2HP	400V → 600V 3HP
Single Phase	120V - 0.5HP	230V-1.5HP
Electrical Life - 1.2 Million ops.		
Mechanical Life-10 million ops.		
Coil Power Consumption		
Coil Pick up	30VA	
Coil Holding	4.5VA	
5kA I.C		



Auxiliary Contacts			
N.O.	N.C.	Part #	List \$
0	2	AUX2.02	\$9.00
2	0	AUX2.20	\$9.00
1	1	AUX2.11	\$9.00
4	0	AUX2.40	\$9.00
0	4	AUX2.04	\$9.00
3	1	AUX2.31	\$9.00
1	3	AUX2.13	\$9.00
2	2	AUX2.22	\$9.00

Coil Voltage AC Suffix	
*A	110V
*C	220V
*D	380V
*G	24V
*K	48V

Dimensions: 3 & 4 Pole Contactor

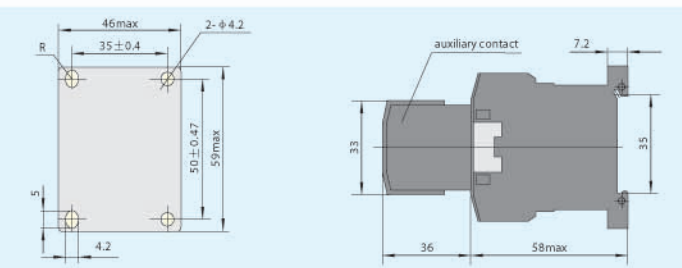

Contactors					
3 Pole					
Part #	List \$	Power poles		Auxiliary Contacts	
		N.O.	N.C.	N.O.	N.C.
ECX2.10-*	\$16.00	3	0	1	0
ECX2.01-*	\$16.00	3	0	0	1

4 Pole Contactor					
Part #	List \$	Power poles		Auxiliary Contacts	
		N.O.	N.C.	N.O.	N.C.
ECX2.40-*	\$17.00	4	0	0	0
ECX2.22-*	\$17.00	2	2	0	0

Motor Starter - Contactor + overload					
Part #	List \$	Power poles		Auxiliary Contacts	
		N.O.	N.C.	N.O.	N.C.
TECX2.10-*0-**	\$38.00	3	0	1	0
TECX2.01-*0-**	\$38.00	3	0	0	1

Plug ON - Overloads			
Suffix **	Amp Range	Part #	List
-A	0.10 - 0.16	ECX2-0.16	\$22.00
-B	0.16 - 0.25	ECX2-0.25	\$22.00
-C	0.25 - 0.40	ECX2-0.40	\$22.00
-D	0.40 - 0.63	ECX2-0.63	\$22.00
-E	0.63 - 1.0	ECX2-1.0	\$22.00
-G	1.0 - 1.6	ECX2-1.6	\$22.00
-GN	1.25 - 2.0	ECX2-2.0	\$22.00
-H	1.6 - 2.5	ECX2-2.5	\$22.00
-I	2.5 - 4.0	ECX2-4.0	\$22.00
-K	4.0 - 6.0	ECX2-6.0	\$22.00
-L	5.5 - 8.0	ECX2-8.0	\$22.00
-M	7.0 - 10	ECX2-10	\$22.00
-N	9.0 - 13	ECX2-13	\$22.00

Overload Dimensions (mm)

